

PIVOT-PRO

C80 Series 125° Snap-on Cam-adjustable Soft-close Mirror Hinges



PRODUCT



DESCRIPTION

- Opening angle: 125°
- Available glass door thickness: 3-6mm
- Adhesion distance (K): 0-16.5mm

APPLICATION

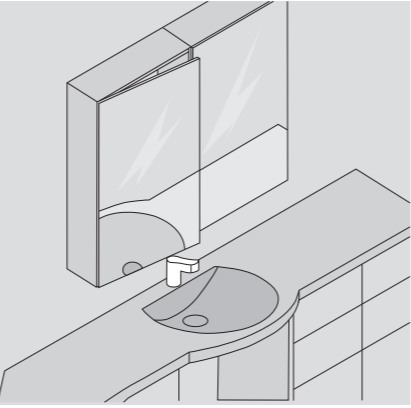

PLANNING

Space needed to open the door													
	T=	3	4	5	6								
	K=1.5	A=	13.6	14.4	15.2	16.1							
	K=3.0	A=	11.2	12.1	12.9	13.8							
	K=4.5	A=	8.9	9.8	10.7	11.6							
	K=6.0	A=	6.8	7.7	8.6	9.5							
	K=7.5	A=	4.2	5.0	5.8	6.6							
	K=8.0	A=	2.8	3.8	4.8	5.8							
			-	-	-	-							
	K=16.5	A=	0	0	0.3	0.8							

Space needed to open the door													
	T=	3	4	5	6								
	K=1.5	L=	0	0	0	0							
	K=3.0	L=	0	0	0	0							
	K=3.5	L=	0	0	0	0							
			-	-	-	-							
	K=16.5	L=	0	0	0	0							
- The above values are calculated on the assumption that the doors have square edges. - They are reduced if the doors have radiused edges.													

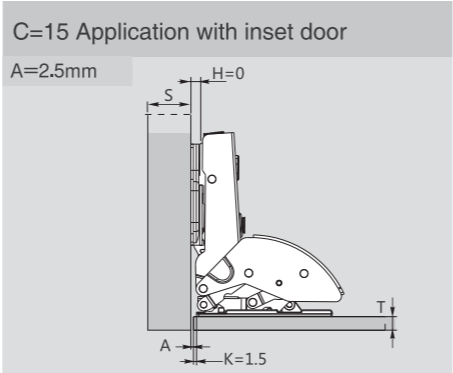
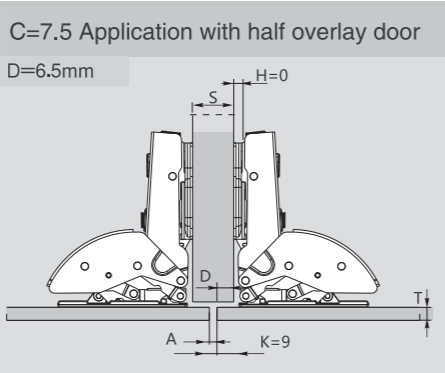
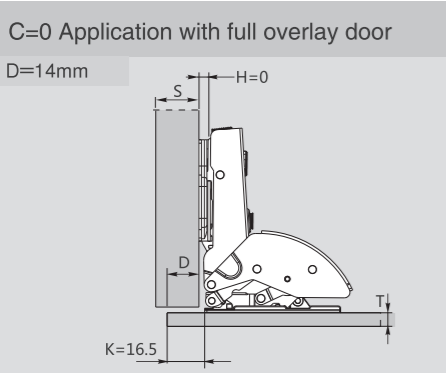

ORDER INFORMATION



Adhesion distance:

Assembly instructions:
Please contact your
glass or door supplier
concerning the right
adhesive and its use.

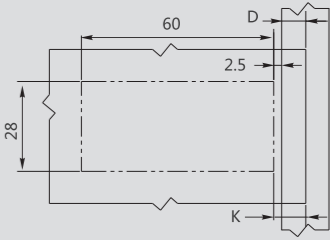

Limitation of liability:
As the adhesive and/or adhesive
process are beyond our control, DTC
cannot accept liability for claims in
this regard.

Use these formulas to determine
the type of hinge arm, the adhesion
distance "K" and the height of the
mounting plate "H" for each door
application.

Caution
Drilling distance: Full overlay, Half overlay X=46, Inset X=46+T+1

$K(\min 0, \max 16.5) = D + 2.5$

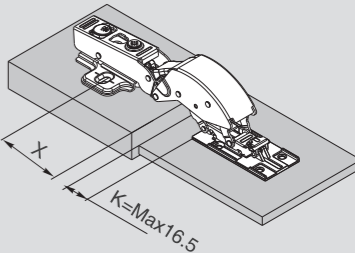

Nickel plated(A01)

C80 Series 125° snap-on cam-adjustable soft-close mirror hinges

Full overlay C=0



$H = -2.5 + K - (D)$

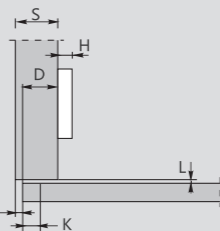

Half overlay C=7.5



$H = -2.5 + K - (D)$

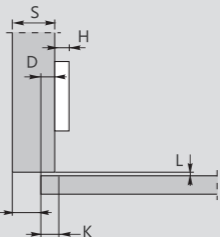

Inset C=15



$H = -2.5 + K + (A)$

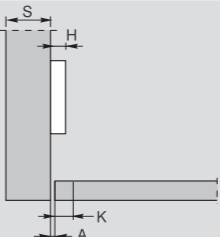

	Item No.	Pcs/ctn
Soft-close	C80A689F	200
Sprung	C80A689	200

	Item No.	Pcs/ctn
Soft-close	C80A689F	200
Sprung	C80A689	200

	Item No.	Pcs/ctn
Soft-close	C80A689F	200
Sprung	C80A689	200