

Drawer Assembly

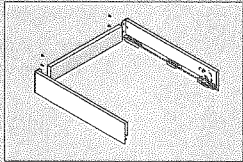

Back assembly

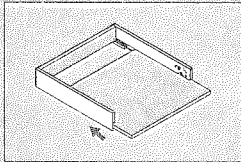

Bottom assembly

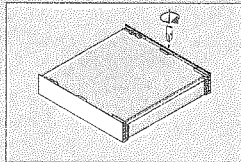

Fix screws

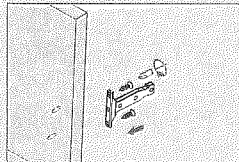

Front assembly

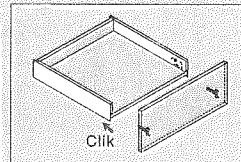

Click

Drawer Assembly

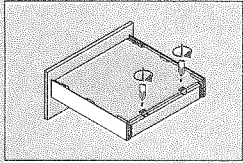

Fixing-brackets assembly

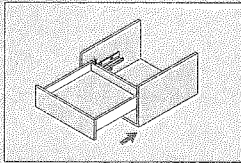

Slide into the cabinet

Adjustments for Lower/Medium Drawer (M/K Height)

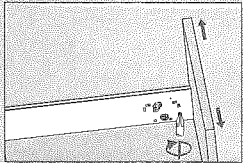

Left&right adjustment

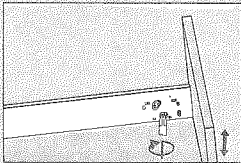

Up&down adjustment

Removal for Lower/Medium Drawer (M/K Height)

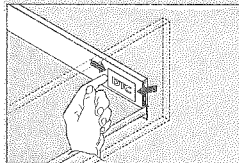

Tip up the cover and pull out

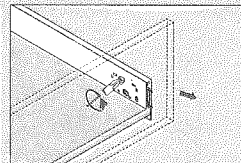

Turn screw driver to release the drawer front

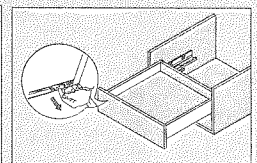

Press the locking device under drawer bottom and pull out the drawer

Adjustments for High Drawer (C Height)

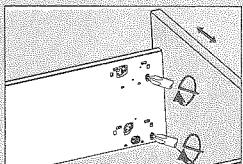

Left&right adjustment

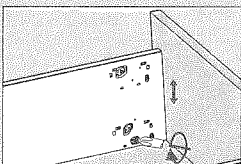

Up&down adjustment

Removal of High Drawer (C Height)

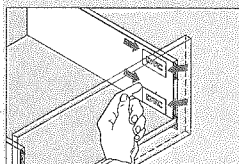

Tip up the cover and pull out

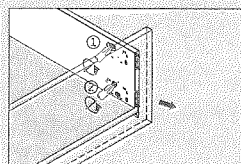

Turn screw driver to release the drawer front

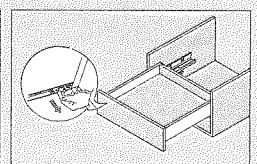

Press the locking device under drawer bottom and pull out the drawer

Low Inner Drawer Front Assembly (M Height)

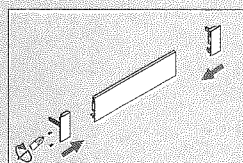

Click

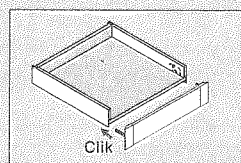

Click

High Inner Drawer Front Assembly (C Height)

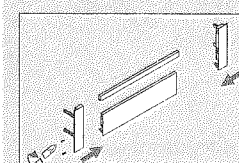

Click

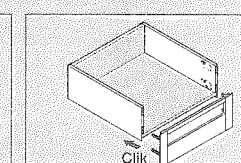

Click

Low Drawer: M Height

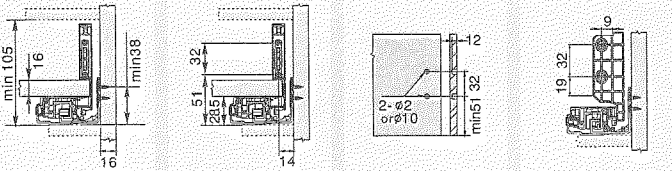

Space requirement in cabinet Front installation dimensions Front drilling dimensions Back installation dimensions

Medium Drawer: K Height

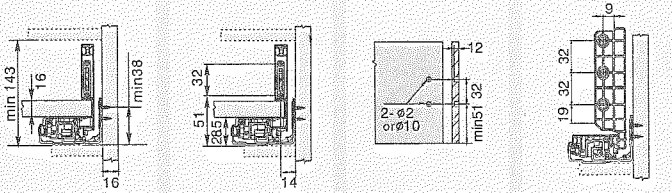

Space requirement in cabinet Front installation dimensions Front drilling dimensions Back installation dimensions

High Drawer: C Height

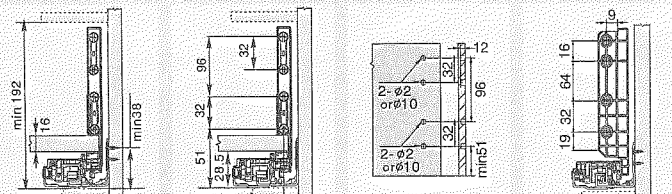

Space requirement in cabinet Front installation dimensions Front drilling dimensions Back installation dimensions

Installation Dimensions

Internal cabinet depth = $LT - NL + 3$

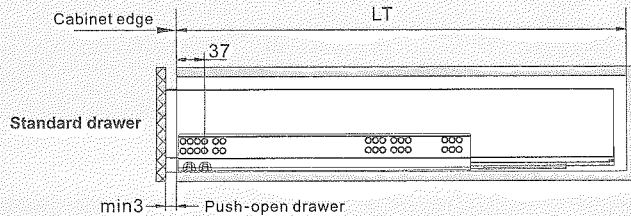

Soft close slides: $LT = NL + 3$

Push-open slides: $LT = NL + 10$

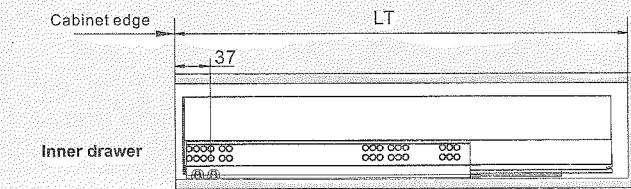

Cutting dimensions for 16mm chipboard

KB Cabinet width
LW Internal cabinet width
NL Nominal length

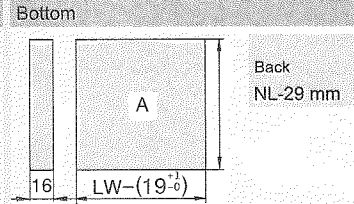
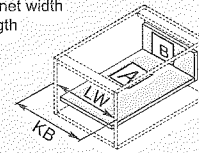

Low Drawer: M Height

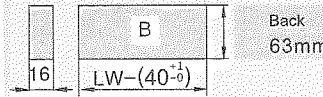

Medium Drawer: K Height

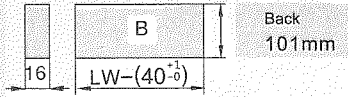

High Drawer: C Height

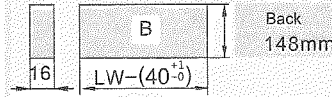

Rod for Push-open Synchronization

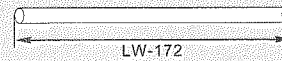

Front section for inner drawer

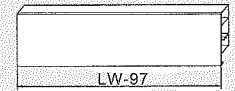

Screw Positions of the Slides

Cabinet edge	NL
	270
	300
	350
	400
	450
	500
	550
	600

Dimensions: 37, 32, 128, 160, 192, 224, 23, 78

Fixing hole position for push-open inner drawer

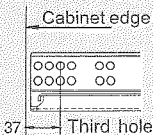

Square Cross Rail

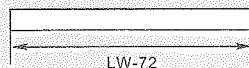

DTC

GUANGDONG DONGTAI HARDWARE PRECISION MANUFACTURING CO., LTD.
Tel.: +86(0)757-25332283 Fax: +86(0)757-25551876
E-mail: dtc@dtcdtc.com Website: www.dtcdtc.com