

Assembly and Adjustment

(for MAGIC-PRO)

Drawer Assembly

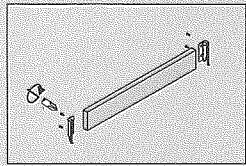

Back assembly

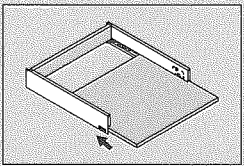
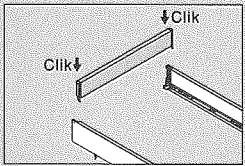

Bottom assembly

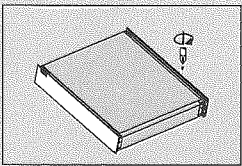

Fix screws

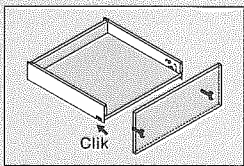
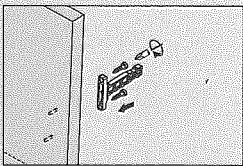

Front assembly

Drawer Assembly

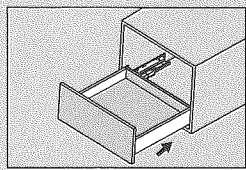

Slide into the cabinet

Adjustment

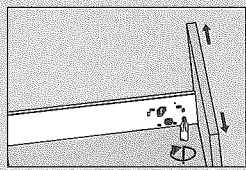

Left&right adjustment

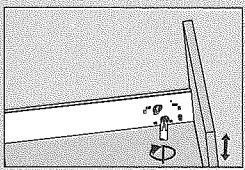

Up&down adjustment

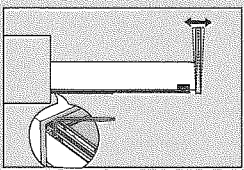

Tilt adjustment (by M3 Allen key)

Removal

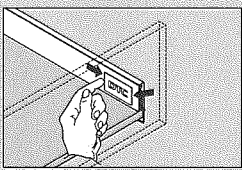

Tip up the cover and pull out

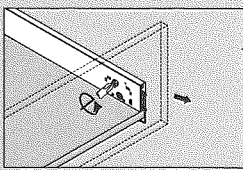

Turn screw driver to release the drawer front

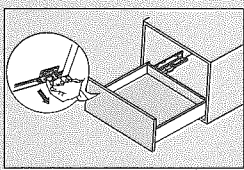

Press the locking device under drawer bottom and pull out the drawer

Adjustments for High Drawer

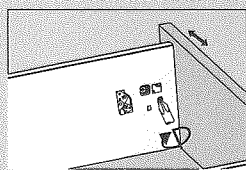

Left&right adjustment

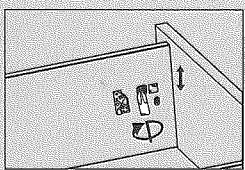

Up&down adjustment

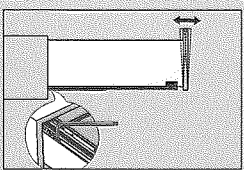

Tilt adjustment (by M3 Allen key)

Removal of High Drawer

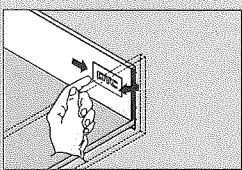

Tip up the cover and pull out

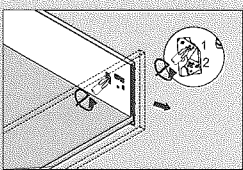

Turn screw driver to release lock 1, then release lock 2, remove the drawer front

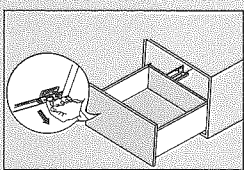

Press the locking device under drawer bottom and pull out the drawer

Assembly for High Drawer Glass-boxside

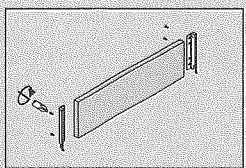

Back assembly

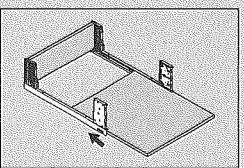
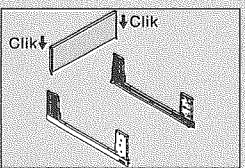

Bottom assembly

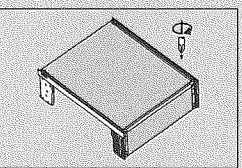

Fix screws

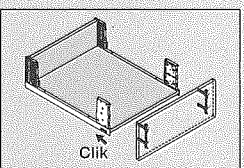
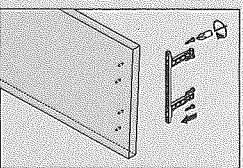

Front assembly

Assembly and Adjustment

(for MAGIC-PRO)

Assembly for High Drawer Glass-boxside

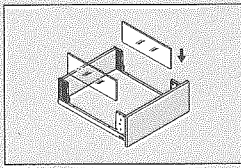

Insert glass-boxside

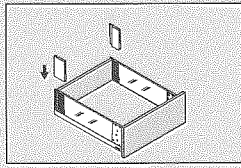

Insert back cover

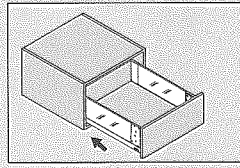

Slide into the cabinet

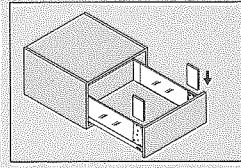

Insert front cover

Adjustment for High Drawer Glass-boxside

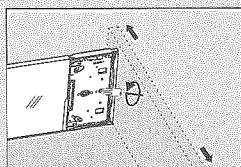

Left & right adjustment

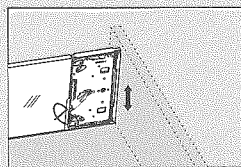

Up & down adjustment

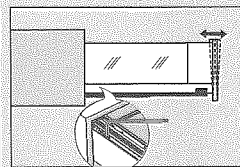

Tilt adjustment (by M3 Allen key)

Removal for High Drawer Glass-boxside

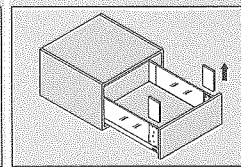

Pull out front cover

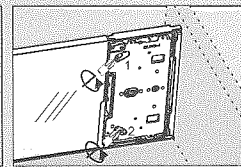

Turn screw driver to release lock 1, then release lock 2, remove the drawer front

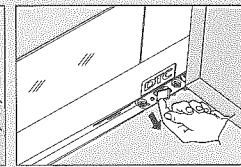

Press the locking device under drawer bottom and pull out the drawer

Low Inner Drawer Front assembly (M Height)

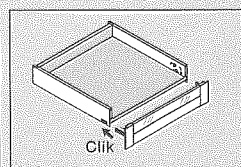
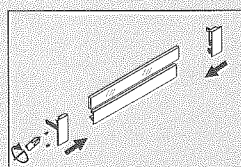

Clik

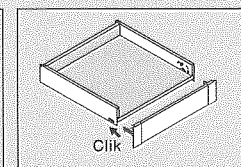
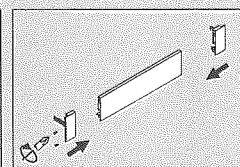

Clik

High Inner Drawer Front assembly (C Height)

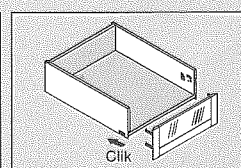
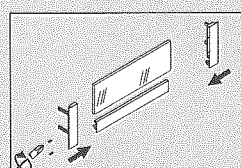

Clik

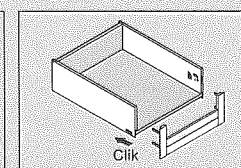
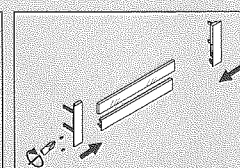

Clik

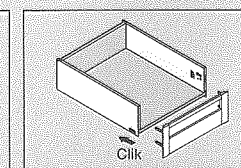
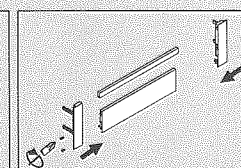

Clik

Super Low Drawer:N Height

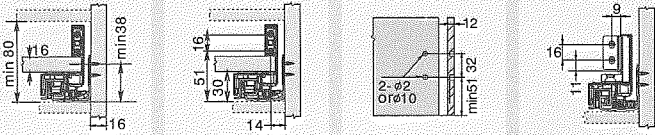

Space requirement in cabinet Front installation dimensions Front drilling dimensions Back installation dimensions

Low Drawer:M Height

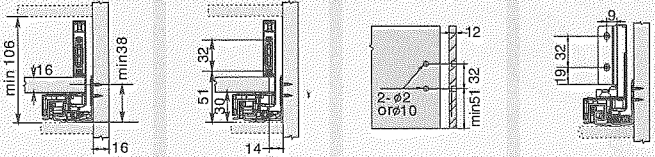

Space requirement in cabinet Front installation dimensions Front drilling dimensions Back installation dimensions

Medium Drawer:K Height

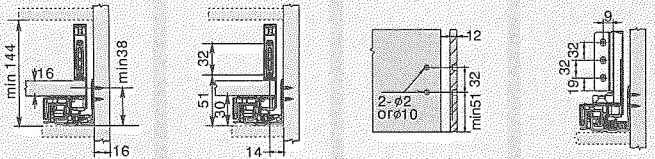

Space requirement in cabinet Front installation dimensions Front drilling dimensions Back installation dimensions

High Drawer:C Height

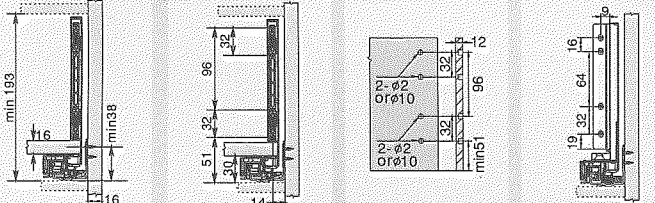

Space requirement in cabinet Front installation dimensions Front drilling dimensions Back installation dimensions

Super High Drawer:F Height

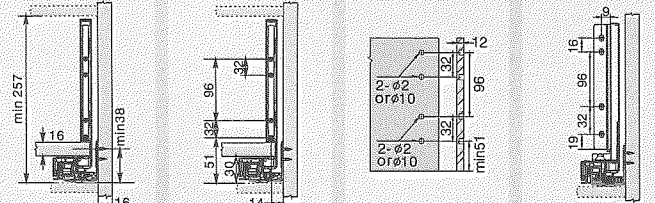

Space requirement in cabinet Front installation dimensions Front drilling dimensions Back installation dimensions

Installation dimensions

Internal cabinet Depth = $LT - LT = NL + 3$

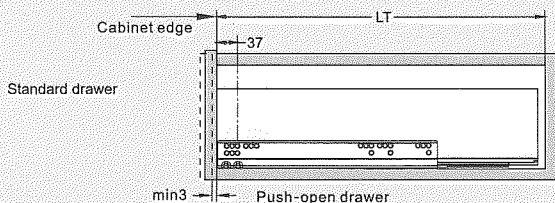

Soft close slides: $LT = NL + 3$

Push-open slides: $LT = NL + 12$

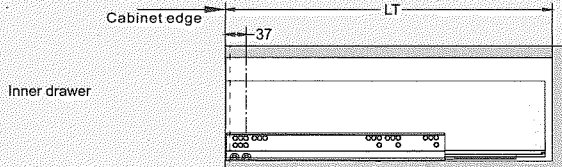

Cutting dimensions for 16mm chipboard

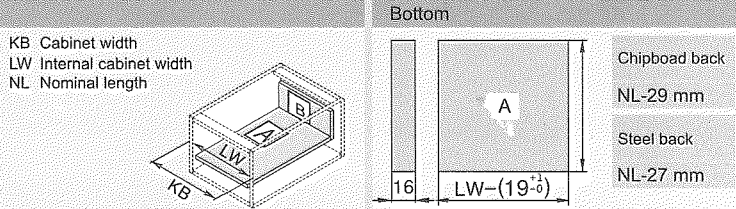

Drawer Type	Back
Super Low Drawer:N Height	39mm
Low Drawer:M Height	63mm
Medium Drawer:K Height	101mm
High Drawer:C Height	148mm
Super High Drawer:F Height	212mm

Screw Positions of the Slides

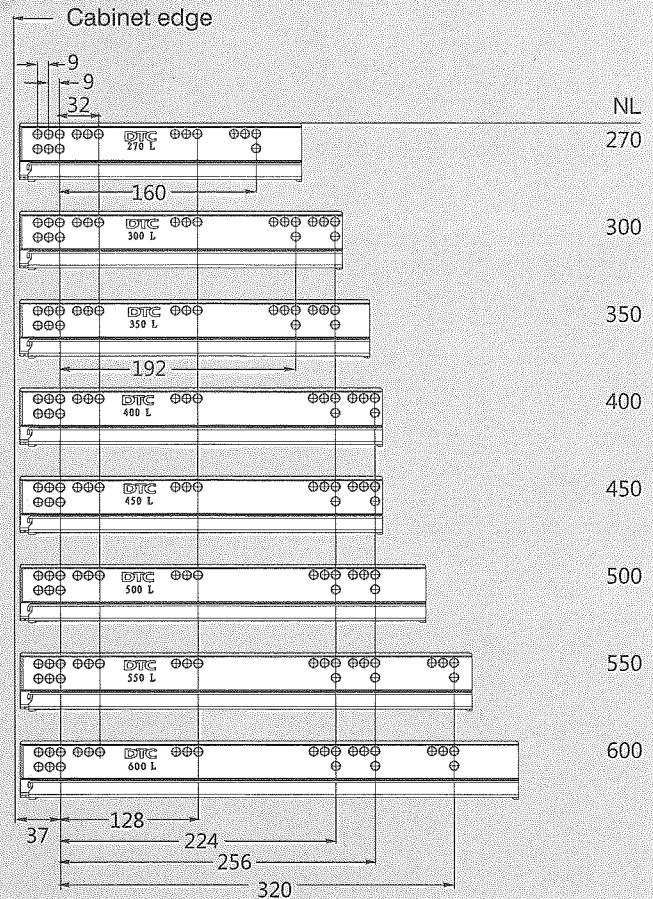

GUANGDONG DONGTAI HARDWARE PRECISION MANUFACTURING CO., LTD.
 Tel.: +86(0)757-25332283 Fax: +86(0)757-25551876
 E-mail: dtc@dtcdtc.com Website: www.dtcdtc.com