

## PRODUCT



## DESCRIPTION

- Opening angle:107°
- Cabinet width up to 1200mm
- Cabinet height:250-500mm
- Door thickness:16-28mm
- 3D door adjustments:  
Height adjustment: +/-2mm,  
Depth adjustment: +/-2mm,  
Side adjustment: +/-2mm,
- Easy to open, and stays at any desired position
- Adjustable soft-closing speed
- Adjustable opening and hovering forces
- Tool free assembly and removal
- Single and dual-colour caps at your disposal

### Power factor LF=

Cabinet height KH(mm) x door weight incl. double handle weight(kg)

Note: The power factor LF and the door weight can be increased by 50% when a third lift mechanism is used.

## ORDER INFORMATION

	Lift Mechanism set/ Industrial Package Opening angle:107°		
	Power Factor LF	Dynamic	Set/ctn
	580-1250	Light	10
	960-2040	Medium	10
1800-3500	Strong	10	
	Opening angle restriction clip / Industrial Package Plastic		
	100°	Dark grey ( H11 )	
	75°	Opening angle	Pcs/ctn
100°	1000		
75°	75°	1000	
	Front Fixing-brackets set/Industrial Package For Wooden Door and Wide Alu Frames		
	Nickel Plated		
	Item No.		
	Set/ctn	200	
	Narrow Alu Frame fixing-brackets set Industrial Package For Narrow Alu Frames		
	Nickel Plated(A01)		
	Item No.		
	Set/ctn	100	
10 pcs Φ3.5X8.5mm countersunk screws included			
	Single Caps(left/right) / Industrial Package		
	Colour	Item No.	Set/ctn
	White		20
	Grey		20
	Dual-colour Caps(left/right) / Industrial Package		
	Colour	Item No.	Set/ctn
	White+ light grey		20
	Grey+ dark grey		20
White+ nickel plated		20	
Grey+ nickel plated		20	

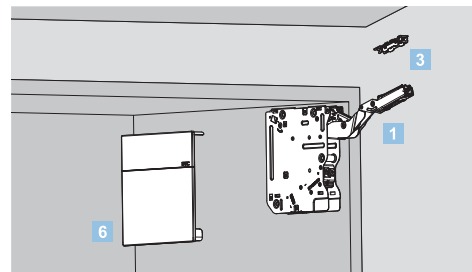
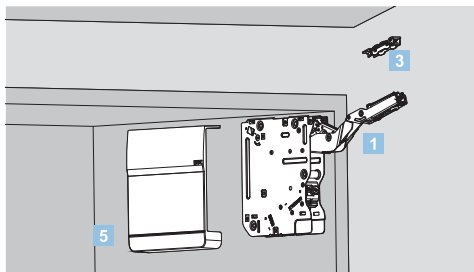

## ORDER INFORMATION

<b>T1 Recommended Kit Package</b> Including: 		
Please select the corresponding kit package item No. according to power factor and cabinet height		
Power Factor(LF)	Cabinet Height	Kit package item No.
580-1250	250-400mm	
960-2040	400-500mm	
1800-3500	500mm	
<b>T2 Recommended Kit Package</b> Including: 		
Please select the corresponding kit package item No. according to power factor and cabinet height		
Power Factor(LF)	Cabinet Height	Kit package item No.
580-1250	250-400mm	
960-2040	400-500mm	
1800-3500	500mm	
<b>T3 Recommended Kit Package</b> Including: 		
Please select the corresponding kit package item No. according to power factor and cabinet height		
Power Factor(LF)	Cabinet Height	Kit package item No.
580-1250	250-400mm	
960-2040	400-500mm	
1800-3500	500mm	
<b>T4 Recommended Kit Package</b> Including: 		
Please select the corresponding kit package item No. according to power factor and cabinet height		
Power Factor(LF)	Cabinet Height	Kit package item No.
580-1250	250-400mm	
960-2040	400-500mm	
1800-3500	500mm	
<b>T5 Recommended Kit Package</b> Including: 		
Please select the corresponding kit package item No. according to power factor and cabinet height		
Power Factor(LF)	Cabinet Height	Kit package item No.
580-1250	250-400mm	
960-2040	400-500mm	
1800-3500	500mm	
<b>T6 Recommended Kit Package</b> Including: 		
Please select the corresponding kit package item No. according to power factor and cabinet height		
Power Factor(LF)	Cabinet Height	Kit package item No.
580-1250	250-400mm	
960-2040	400-500mm	
1800-3500	500mm	

# TOP-STAYS

## SQ Series Lifting System

# TOP-STAYS

## Assembly , Removal and Adjustment(for SQ series Lifting System)

### PLANNING

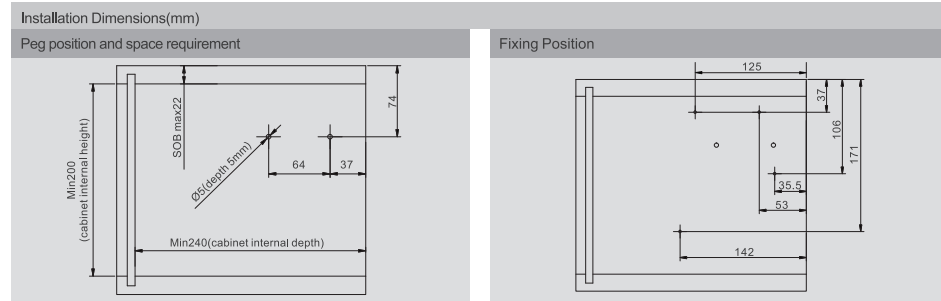

### Door planning and assembly- wooden doors and wide alu frames

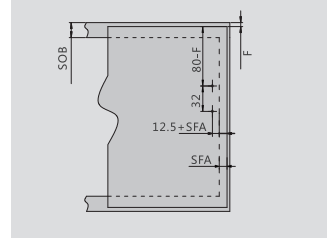

4 wooden screws for wooden doors (Ø4X16mm)  
4 countersunk screws for wide alu frames (M4X11mm)  
SFA: door overlay of the side panel  
F: gap

### Door planning and assembly- narrow alu frames

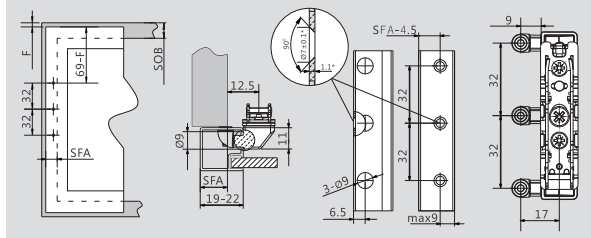

Frame width(mm)	19	20	21	22
SFA(mm)	15~19	16~20	17~21	18~22

10 countersunk screws for narrow alu frames (Φ3.5X8.5mm)  
\*When changing material thickness, adjust the assembly dimensions accordingly

### Cornice/crown moulding clearance

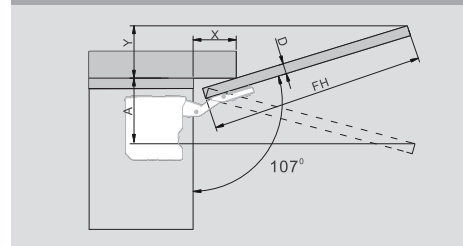

D(mm)	16	19	22	26	28
X(mm)	70	58	49	35	26
Opening angle restriction	Space requirement (mm)				
without	$Y = FH \times 0.29 - 15 + D$				
100°	$Y = FH \times 0.17 - 15 + D$				
75°	$A = FH \times 0.26 + 15 - D$				

### Minimum gap

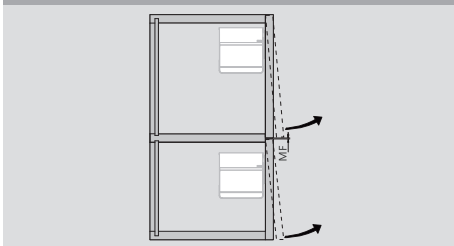

### Assembly

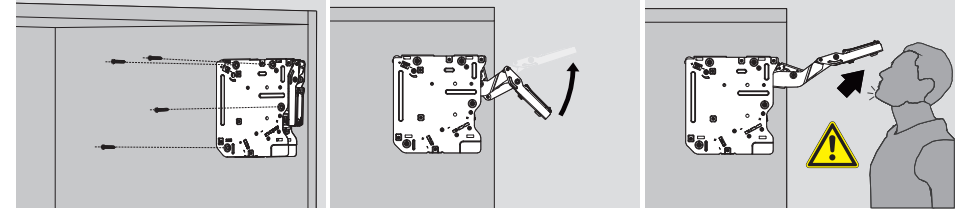

Assembly

Caution when opening arm

The arm of this device could spring up and cause injury. Do not push the arm down without door attached.

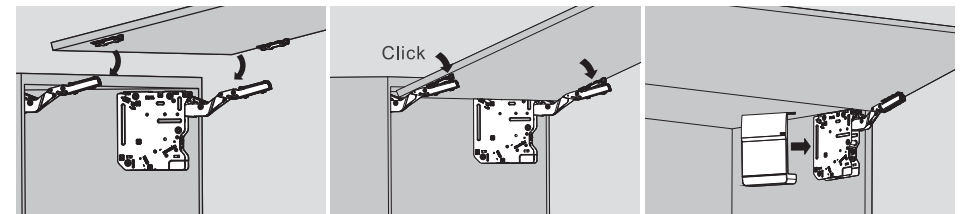

Door Assembly

### Hovering Adjustment

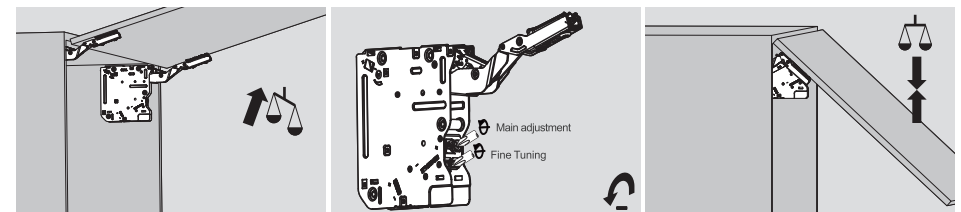
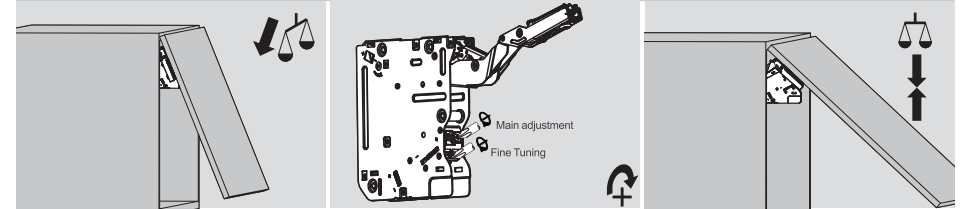

# TOP-STAYS

Assembly , Removal and Adjustment(for SQ series Lifting System)



## Closing Speed Adjustment

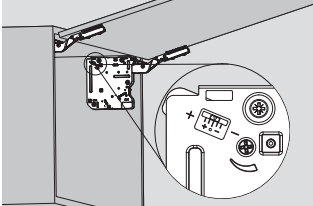

"+" increasing soft-closing time (turn adjustment screw counter-clockwise)  
 "-" reducing soft-closing time (turn adjustment screw clockwise)

## Door Position Adjustment

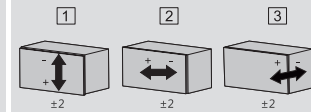
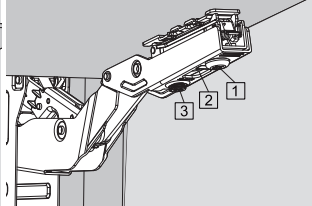
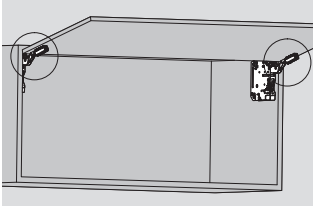

## Opening angle restriction clip

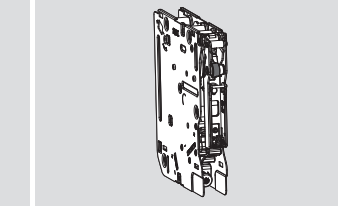
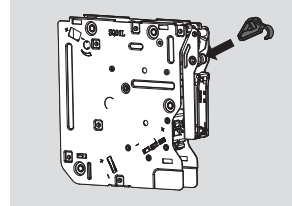

Assembly

## Removal

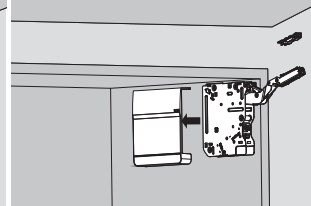
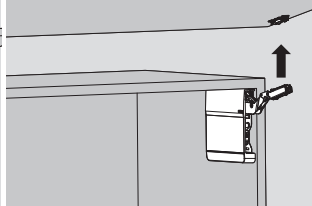
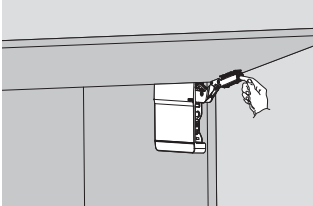

The arm of this device could spring up and cause injury!

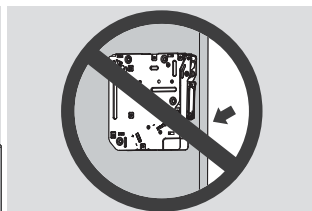

Do not push the arm down without door attached

